

19m PATROL BOAT MTU 10V 2000

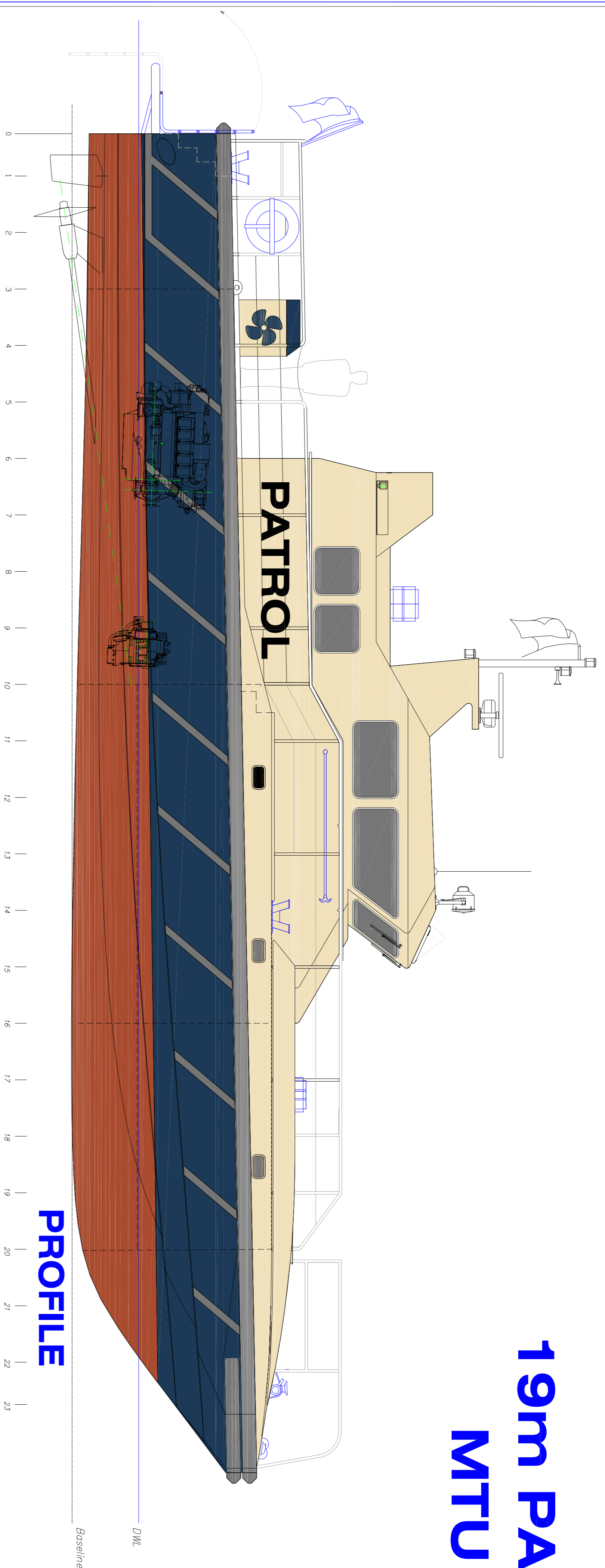

PROFILE

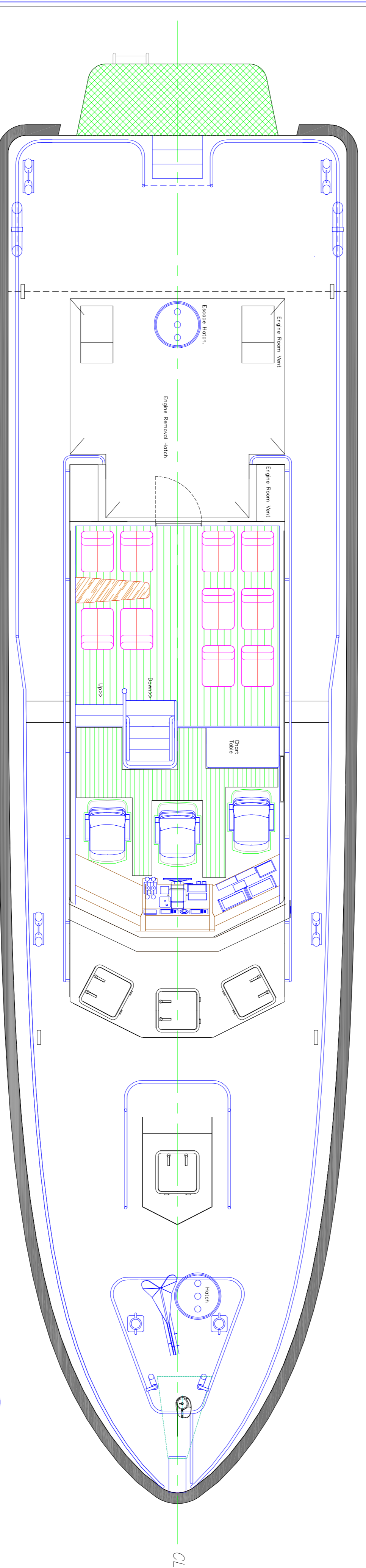

MAIN DECK PLAN

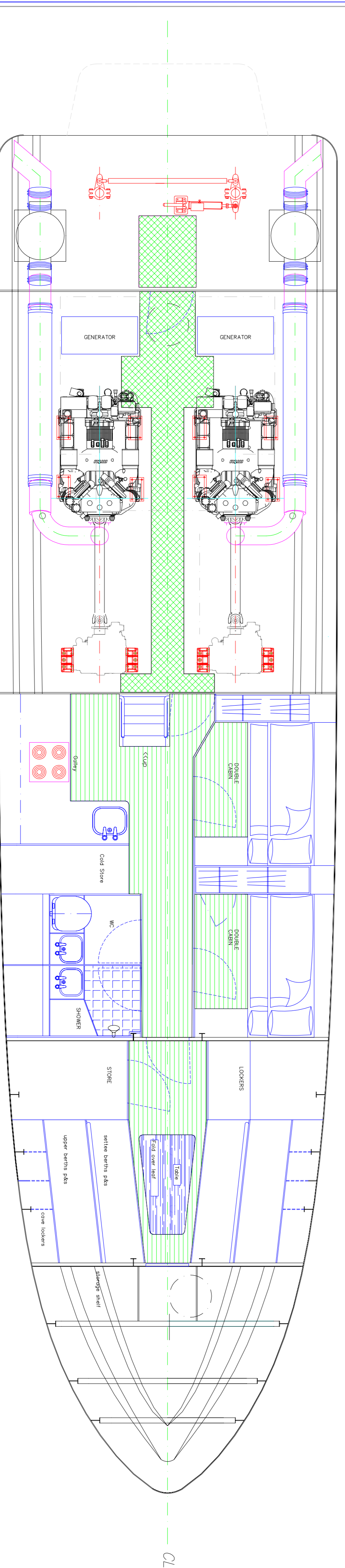

LOWER DECK PLAN

PARTICULARS

Length Overall	20.2m
Length Hull	18.9m
Length Waterline	17.3m
Beam Overall	5.0m
Beam Moulded	4.7m
Draught, approx.	1.5m

ISSUE 02 Contract – 19/04/10

19m PATROL BOAT

GENERAL ARRANGEMENT

Drawing No P19-AMT-SVITZER-GA Scale: 1:40 @ A1 By: AS

ALNMARITEC LTD

Alnmartec, Willowburn Industrial Estate, Alnwick
Northumberland, NE66 2PQ
Tel. (+44)01665 602917 Tel. (+44)01665 605399
Email: sales@alnmartec.co.uk

CAMARC DESIGN

All rights reserved.

Southern Office:
St. Julian's Hall, 68 Brighton Rd
Shoreham, Sussex, BN43 6R6, England, UK
Tel: +44 (0)1273 593096
Fax: +44 (0)1273 593086

Northern Office:
Aronvale, Bullock Road, Dunroon,
Argyll, PA23 7DN, Scotland, UK
Tel: +44 (0)1569 701930
Fax: +44 (0)1569 709118
E-Mail: sales@camarc.com Web: www.camarc.com